

West Hill Kettering Kettering, Northamptonshire

Kier Living

BIG Challenge 2015 submission category: Large scale permanent

Project overview

The project is to provide a country park, allotments, 500 houses, and communal areas, the country park includes, orchards, woodlands, open grass areas, look after SUDS basin which is designed as part of the overall landscaping areas.

A new badger sett has also been provided, enabling the existing badger sett to be moved. The local authority and parish council were involved with the design.

What were the biodiversity conditions on site, prior to the enhancement?

The Original land was open farm land.

Were there any specific conditions that led to you carrying out this work?

The site is required to achieve Code Level three on all the houses, and the Country Park is in agreement with the Planning authority.

The concept of the Country Park was part of the stratagem agreed with the land owner who wished to see the land being used to enhance the local area.

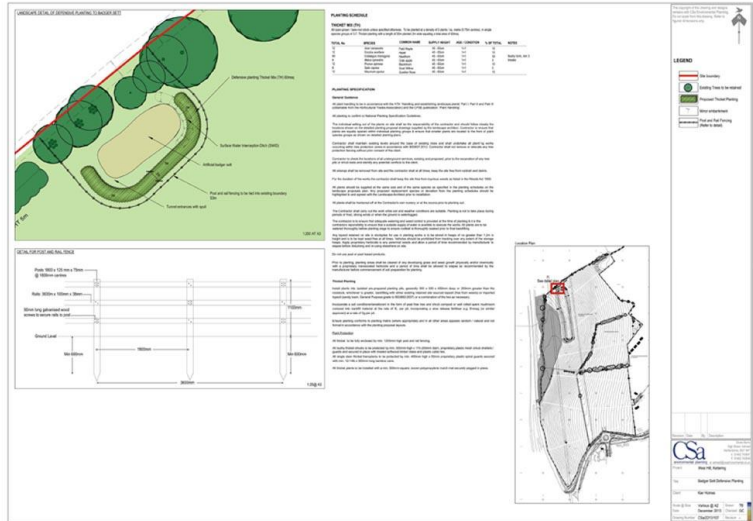

Photo: Badger Sett Planting Plan

What were the biodiversity measures taken?

The country park will enable local species to thrive in this area, with additional benefits of planting local species of orchard trees from an existing local orchard to ensure continuity of this species which is now rear.

The local community were involved in the planning process of the county park.

The residents will have the benefit of the allotments on site, to enable them to participate in the overall concept of promoting biodiversity on the

development, and the sales and marketing literature gives suggestions for this.

The whole area is covered by a management company, which all residents contribute to, to ensure the long term maintenance of this Country Park.

The staff on site have all been involved in the creation of the Country Park, and have been made aware of its enhancements to the local community.

There have been forums on site such as the Groups Environmental Managers, to show them the site and explain the benefits that the

Country Park brings to the local community, as well as the residents on site.

An existing badger set on site has been relocated, by building a new set, and then encouraging the badgers to move into the new set.

There is a very detailed specification that has been provided to ensure the future maintenance of the Country park.

How would you best describe the project?

An enhancement.

Further information

The Country Park was laid out to be in existence in two phases, both of which were designed to be in place before occupation of the first houses on site, so that residents could benefit from the park when they moved in.

It also demonstrated Kier Livings commitment to the local community to provide the Country Park as part of the development at an early stage so it could be used by them as quickly as possible as part of the new facilities being provided for the community.



Photo: Masterplan

What was your personal motivation for carrying out the enhancement?

The development was carried out as part of a long term programme to enhance the local area with Housing, whilst providing additional benefits both in terms of biodiversity and communal facilities to the local residents.