

A14 J7-9 Kettering Bypass Improvement Scheme Kettering, Northamptonshire

bmJV (BAM Nuttall & Morgan Sindall plc)

BIG Challenge 2015 submission category: Large scale permanent

Project overview

The A14 J7-9 scheme was a Highways Agency Scheme to add an additional lane to the carriageway by online widening - to create a 3-lane dual carriageway around Kettering.

To construct the scheme major civils works were required including site clearance, earthworks, drainage installation, building retention solutions, bridge structure modifications and a landscaping scheme.

Work commenced in early 2014 with landscaping works finished spring 2015.

What were the biodiversity conditions on site, prior to the enhancement?

The scheme area consisted of semi improved grassland with scrub and broadleaf woodland, mixed between embankments and cuttings.

The landscape provided habitat for various protected species including Breeding Birds.

The area adjacent to the scheme was heavily dominated by agriculture



Photo: Road Overview

with a poor hedgerow network providing little habitat connectivity.

Were there any specific conditions that led to you carrying out this work?

Due to the nature of the works required, it was necessary to minimise the loss as far as practicable of existing features of importance, safeguard protected species and provide new and enhanced habitats to increase biodiversity in the locality.

What were the biodiversity measures taken?

In order to preserve protected species and

encourage biodiversity after scheme completion the A14 team carried out planting of local provenance trees and shrubs.

It was decided that the shrubs should be berry producing varieties including wild privet, wild cherry, blackthorn and guelder rose to become a food source for overwintering birds.

Berries are an important food source for many birds during the winter, especially when the ground is too frozen to hunt worms or snails, and there are few insects about.

How would you best describe the project?

An enhancement.

Further information

The planting of whips was undertaken during the first few months of 2015.

Regular monitoring and maintenance including weeding and replacement of failed plants will be undertaken during a 3 year aftercare period.

What was your personal motivation for carrying out the enhancement?

It was essential to deliver this project to relieve congestion in the locality, however road verges provide brilliant habitat for many species.

The aim was to influence the retention of existing habitat and ensure that permanent losses were compensated for with enhancements to retain and attract new species.



Photo: Planted embankment

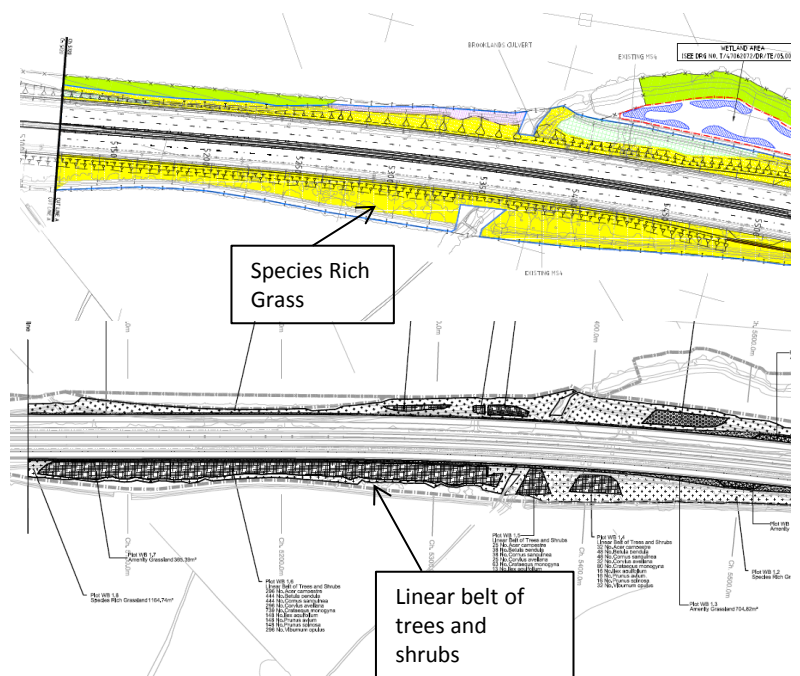

Photo: Planting design